

## Quick configuration Guide for H-HDPerformux- 8/16/24

**Login instructions:**

**In order to log in to the Modulator NMS port, please set your PC's NIC Ethernet card to the following IP address: 192.168.0.100.**

**Access Modulator GUI by typing derail IP address 192.168.0.136 in to the browser**

**Login /password – admin/admin**

192.168.0.136

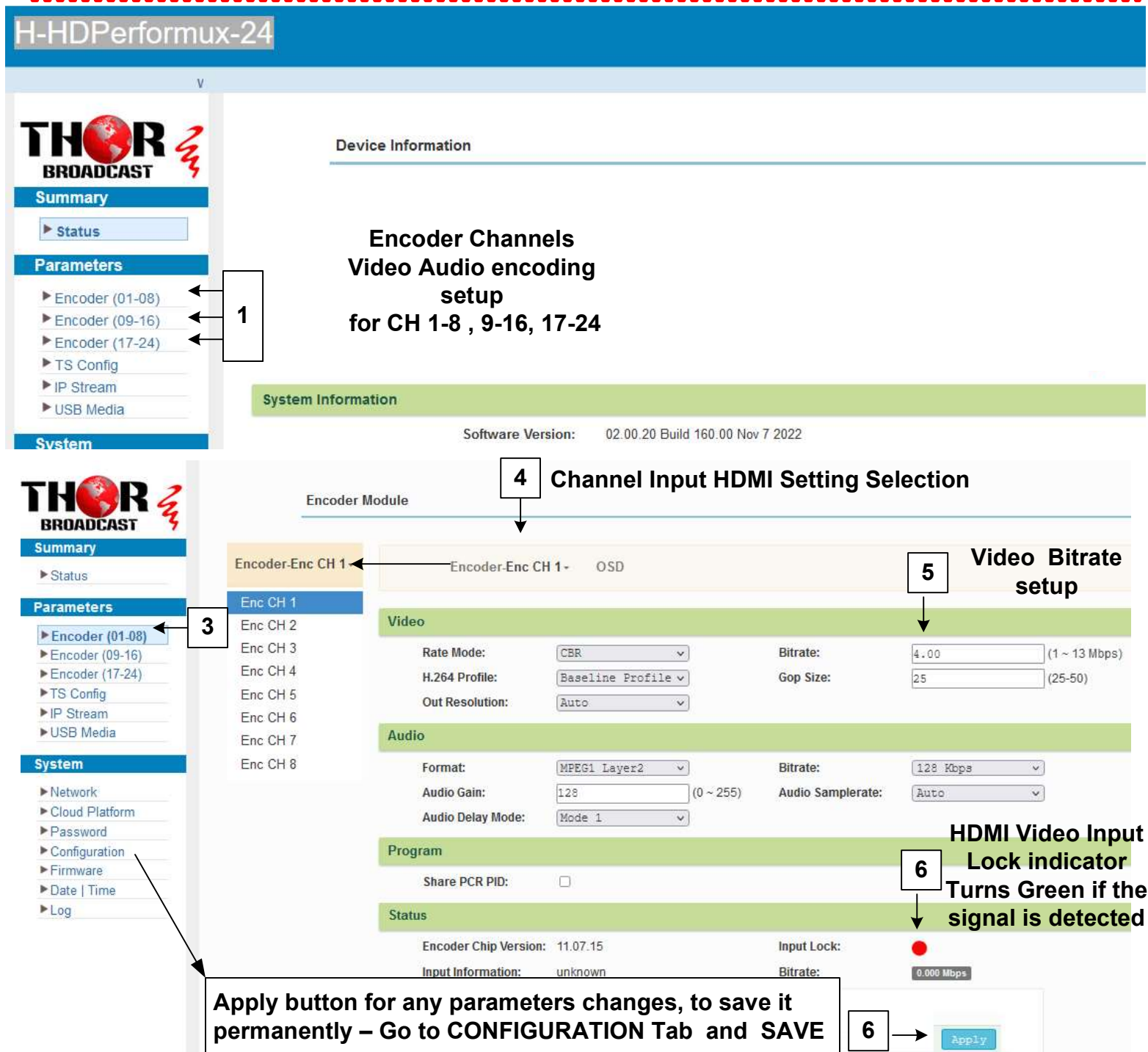

Ver.2023

<https://thorbroadcast.com>

**800-521-8467**

**sales@thorfiber.com**



This page controls which HDMI Input CH 1-24 or ASI or USB (in MPTS ) are selected and moved to the IPTV outputs  
By default all 24 channels are selected

## H-HDPerformux-24

**TS Config**

**Stream Select**

**SPTS ( single program transport stream or MPTS (Multiprogram transport stream selection))**

**HDMI inputs encoded transport streams**

**Parse the program (scanning function)**

**Click Digit 1 to 24 to open Program information page**

## Program PID's Information

Program From Input: Encoder (01-08) SPTS:1 [101]

**Name**

Service Name:

Program Number:

Service Type:

Service Provider:

PMT Descriptor Tag: ☐ 0x00

PMT Descriptor Data:  (Hex)

PMT PID:

PCR PID:

MPEG-4 Video PID: ☒

MPEG-1 Audio PID: ☒

#	IP Address	Port	Protocol	Pkt Length	Null PKT Filter	Status	Bit(Act/Max)	
MPTS1	224.2.2.2	2001	UDP	7	<input type="checkbox"/>		0.0/120.0 M	
SPTS1	224.2.2.2	2002	UDP	7	<input type="checkbox"/>		0.1/30.0 M	
SPTS2	224.2.2.2	2003	UDP	7	<input type="checkbox"/>		0.1/30.0 M	
SPTS3	224.2.2.2	2004	UDP	7	<input type="checkbox"/>		0.1/30.0 M	
SPTS4	224.2.2.2	2005	UDP	7	<input type="checkbox"/>		0.1/30.0 M	
SPTS5	224.2.2.2	2006	UDP	7	<input type="checkbox"/>		0.1/30.0 M	
SPTS6	224.2.2.2	2007	UDP	7	<input type="checkbox"/>		0.1/30.0 M	
SPTS7	224.2.2.2	2008	UDP	7	<input type="checkbox"/>		0.1/30.0 M	
SPTS8	224.2.2.2	2009	UDP	7	<input type="checkbox"/>		0.1/30.0 M	
SPTS9	224.2.2.2	2010	UDP	7	<input type="checkbox"/>		0.1/30.0 M	

Quickly Config.

ENABLE ON/OFF

Enable: ☒

IP Address: 224.2.2.2

Port: 2001

Step: 1

Bitrate(Mbps): 20.0

Protocol: UDP

Pkt Length: 7

Null PKT Filter: ☐

Apply

Multicast or unicast IP address

Port number

Total Bit rate – need to be > than Video Bit rate

UDP or RTP or RTSP selection

Null Packet ON/OFF Function

Apply

VLC media player

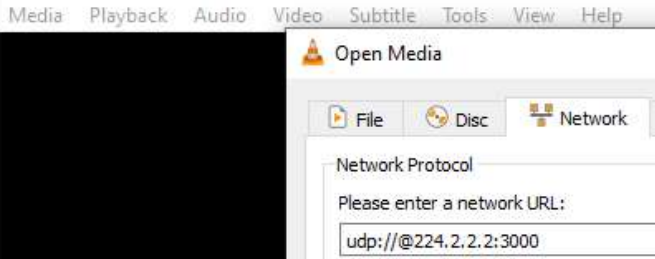

IPTV streaming is sent out from the data port and can be tested using VLC player.

UDP syntax example is `udp://@224.2.2.2:2001`

RTP syntax example is `rtp://@224.2.2.2:2001`

RTSP syntax example is `rtsp://(DATA IP ADDRESS):5000/1-4`

1. Click the pencil icon for MPTS's or SPTS's section. Drop box will open to configure channel 1

2. Enable and edit your IP preferences

3. Press apply

DATA

IP Address: 192.168.2.136

Subnet Mask: 255.255.255.0

Gateway: 192.168.2.1

MAC Address: 22:d5:12:2a:04:59

## Configuration Saving / Backup / Restore

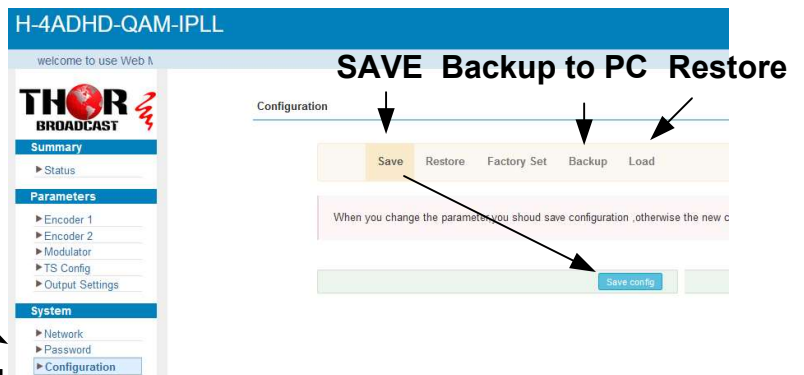

1. Click the configuration tab on the left hand side

2. Click the save tab

3. Press save config –

**YOU MUST SAVE OR ALL CHANGES WILL BE LOST AFTER RESTART!**